

# Illustrated Index

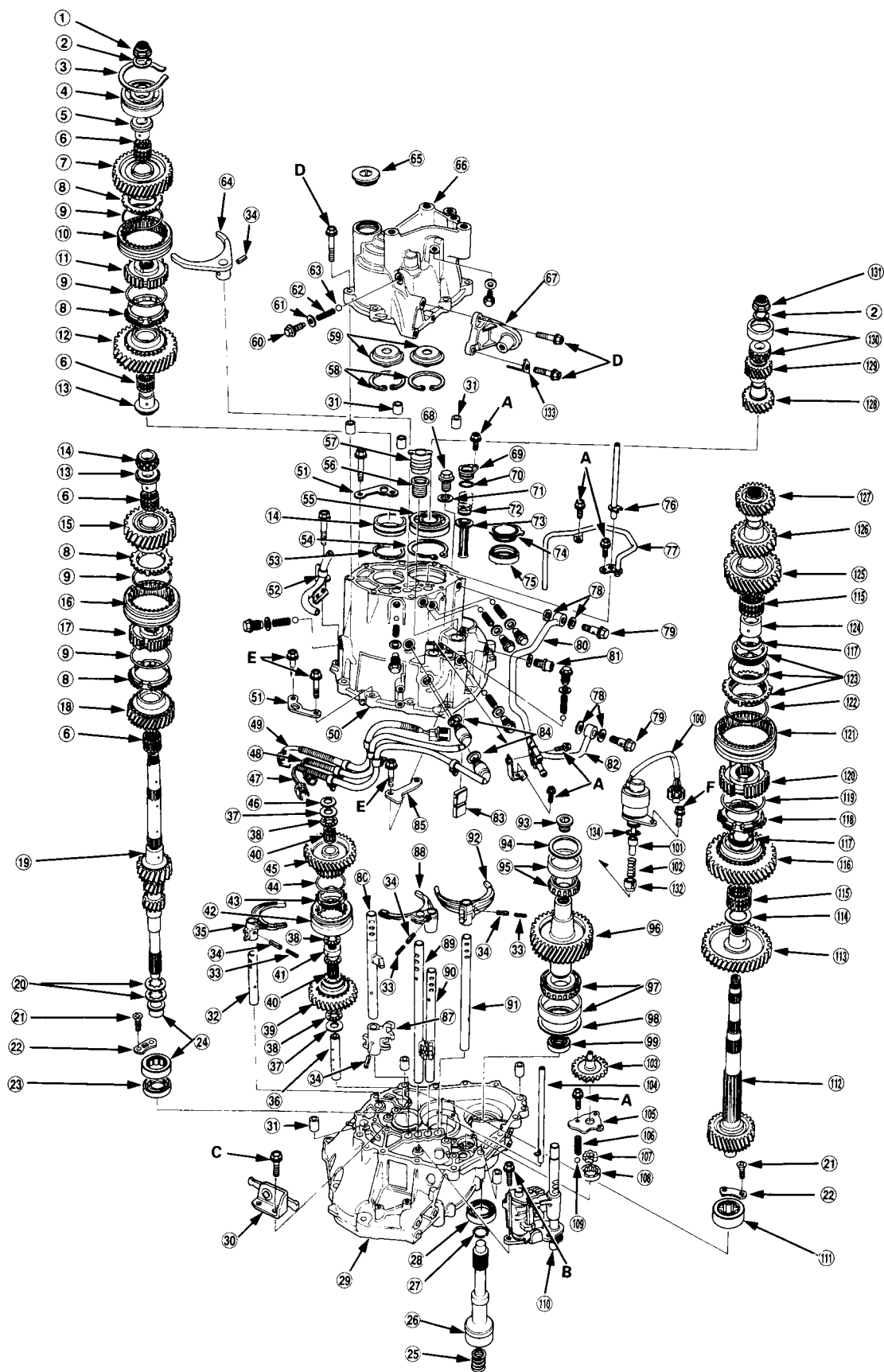



NOTE: Always clean the magnet ⑧③ whenever the transmission housing is disassembled.

	Torque Value	Bolt Size
A	12 N·m (1.2 kg-m, 9 lb-ft)	6 x 1.0 mm
B	15 N·m (1.5 kg-m, 11 lb-ft)	6 x 1.0 mm
C	26 N·m (2.6 kg-m, 19 lb-ft)	8 x 1.25 mm
D	28 N·m (2.8 kg-m, 20 lb-ft)	8 x 1.25 mm
E	45 N·m (4.5 kg-m, 33 lb-ft)	10 x 1.25 mm
F	14 N·m (1.4 kg-m, 10 lb-ft)	6x 1.0 mm

- ① LOCKNUT Replace.  
185 → 0 → 185 N·m  
(18.5 → 0 → 18.5 kg-m,  
134 → 0 → 134 lb-ft)
- ② SPRING WASHER
- ③ SNAP RING
- ④ BALL BEARING
- ⑤ 28 x 38 x 34 mm SPACER COLLAR
- ⑥ 38 x 44 x 29.5 mm NEEDLE BEARING
- ⑦ 6TH GEAR
- ⑧ SYNCHRO RING
- ⑨ SYNCHRO SPRING
- ⑩ 5TH/6TH SYNCHRO SLEEVE
- ⑪ 5TH/6TH SYNCHRO HUB
- ⑫ 5TH GEAR
- ⑬ 31 x 38 x 34 mm SPACER COLLAR
- ⑭ NEEDLE BEARING
- ⑮ 4TH GEAR
- ⑯ 3RD/4TH SYNCHRO SLEEVE
- ⑰ 3RD/4TH SYNCHRO HUB
- ⑱ 3RD GEAR
- ⑲ MAINSHAFT
- ⑳ MAINSHAFT WASHERS
- ㉑ FLAT SCREW Replace.
- ㉒ NEEDLE SET PLATE
- ㉓ 28 x 43 x 7 mm OIL SEAL Replace.
- ㉔ 28 x 53 x 19 mm NEEDLE BEARING
- ㉕ SECONDARY SPRING
- ㉖ EXTENSION SHAFT
- ㉗ SET RING Replace.
- ㉘ 55 x 75 x 11 mm OIL SEAL Replace.
- ㉙ CLUTCH HOUSING
- ㉚ REVERSE SHIFT HOLDER
- ㉛ 14x20 mm DOWEL PIN
- ㉜ REVERSE SHIFT FORK SHAFT
- ㉝ 3 x 22 mm SPRING PIN Replace.
- ㉞ 5 x 22 mm SPRING PIN Replace.
- ㉟ REVERSE SHIFT FORK
- ㊱ REVERSE GEAR SHAFT
- ㊲ 20 x 36 x 2 mm THRUST WASHER
- ㊳ 20 x 37 x 2.5 mm NEEDLE BEARING
- ㊴ REVERSE DRIVE GEAR
- ㊵ 20 x 25 x 26.5 mm NEEDLE BEARING
- ㊶ 20 x 36 x 9.5 mm SPACER COLLAR
- ㊷ REVERSE SYNCHRO SLEEVE
- ㊸ SYNCHRO RING
- ㊹ SYNCHRO SPRING
- ㊺ REVERSE SYNCHRO HUB
- ㊻ SPRING WASHER
- ㊼ NEUTRAL POSITION SWITCH  
25 Nm (2.5 kg-m, 18 lb-ft)
- ㊽ BACK-UP LIGHT SWITCH  
25 Nm (2.5 kg-m, 18 lb-ft)
- ㊾ REVERSE LOCKOUT SUB HARNESS
- ㊿ TRANSMISSION HOUSING
- ① TRANSMISSION HANGER
- ② TUBE CLAMP
- ③ 62 mm SNAP RING
- ④ 78 mm SNAP RING
- ⑤ 32 x 78 x 20 mm BALL BEARING
- ⑥ 16 x 27 x 16 mm OIL SEAL Replace.
- ⑦ SHIFT ROD BOOT
- ⑧ SNAP RINGS
- ⑨ OIL GUIDE PLATES
- ⑩ SEALING BOLT
- ⑪ SEALING WASHER Replace.
- ⑫ SPRING L. 210 mm (0.83 in)
- ⑬ STEEL BALL D. 5/16 in
- ⑭ 5TH/6TH SHIFT FORK
- ⑮ 36 mm SEALING BOLT  
25 Nm (2.5 kg-m, 18 lb-ft)
- ⑯ TRANSMISSION COVER
- ⑰ EXTENSION STAY
- ⑱ OIL FILLER PLUG  
45 Nm (4.5 kg-m, 33 lb-ft)
- ⑲ STRAINER COVER
- ㉑ 29.7 X 2.4 mm O-RING Replace.
- ㉒ WASHER Replace.
- ㉓ STRAINER SET SPRING
- ㉔ OIL PUMP STRAINER
- ㉕ SECONDARY COVER
- ㉖ 45 x 61 x 8 mm OIL SEAL Replace.
- ㉗ OIL GUIDE PIPE
- ㉘ REVERSE PIPE
- ㉙ WASHERS Replace.
- ㉚ JOINT BOLT  
29 Nm (2.9 kg-m, 21 lb-ft)
- ㉛ OIL PUMP PIPE B
- ㉜ DRAIN PLUG
- ㉝ 40 Nm (4.0 kg-m, 29 lb-ft)
- ㉞ OIL PUMP PIPE A
- ㉟ MAGNET
- ㊱ WASHERS Replace.
- ㊲ TRANSMISSION STAY
- ㊳ REVERSE SHIFT SHAFT
- ㊴ REVERSE SHIFT PIECE
- ㊵ 3RD/4TH SHIFT FORK
- ㊶ 5TH/6TH SHIFT FORK SHAFT
- ㊷ 3RD/4TH SHIFT FORK SHAFT
- ㊸ 1ST/2ND SHIFT FORK SHAFT
- ㊹ 1ST/2ND SHIFT FORK
- ㊺ 36 mm SEALING BOLT  
80 Nm (8.0 kg-m, 58 lb-ft)
- ㊻ 75 mm THRUST SHIM  
Selection, page 13-46
- ㊼ TAPERED ROLLER BEARING
- ㊽ SECONDARY GEAR
- ㊾ TAPERED ROLLER BEARING
- ㊿ 90 mm THRUST WASHER
- ① 37.5 x 47 x 7 mm OIL SEAL  
Replace.
- ② REVERSE LOCKOUT SOLENOID
- ③ SELECT LOCK PIN
- ④ SELECT LOCK RETURN SPRING
- ⑤ OIL PUMP SHAFT
- ⑥ OIL GUIDE PIPE C
- ⑦ OIL PUMP PLATE
- ⑧ RELIEF VALVE SPRING  
L. 16.84 mm (0.663 in)
- ⑨ OIL PUMP INNER ROTOR
- ⑩ OIL PUMP OUTER ROTOR
- ⑪ STEEL BALL D. 5/16 in
- ⑫ CHANGE HOLDER
- ⑬ 33 x 62 x 22 mm NEEDLE BEARING
- ⑭ COUNTERSHAFT
- ⑮ REVERSE GEAR
- ⑯ 60 mm THRUST SHIM  
Selection, page 13-41
- ⑰ 47 x 53 x 31 mm NEEDLE BEARING
- ⑱ 1ST GEAR
- ㉑ FRICTION DAMPER
- ㉒ SYNCHRO RING
- ㉓ SYNCHRO SPRING
- ㉔ 1ST/2ND SYNCHRO HUB
- ㉕ 1ST/2ND SYNCHRO SLEEVE
- ㉖ SYNCHRO SPRING
- ㉗ DOUBLE CONE SYNCHRO
- ㉘ SPACER  
Selection, page 13-41
- ㉙ 2ND GEAR
- ㉚ 3RD GEAR
- ㉛ 4TH GEAR
- ㉜ 5TH GEAR
- ㉝ 6TH GEAR
- ㉞ 28 x 62 x 16 mm NEEDLE BEARING
- ㉟ LOCKNUT Left-hand threads  
Replace.  
165 → 0 → 165 N·m  
(16.5 → 0 → 16.5 kg-m,  
119 → 0 → 119 lb-ft)
- ㊱ SELECT LOCK COLLAR
- ㊲ SOLENOID CONNECTOR CLAMP
- ㊳ 16.8 x 1.9 mm O-RING Replace.